

Injection Valve EV 6

www.bosch-motorsport.com



- ▶ Single beam or twin beam
- ▶ Flow rate at 3 bar: up to 962 cm³/min
- ▶ Spray angle 15 to 70°

EV 6 injection valves are designed to inject the fuel as efficiently as possible into the intake manifold runner to achieve a homogeneous distribution of fuel in air flow.

EV 6 injection valves feature high corrosion resistance and excellent engine start characteristics. The hydraulic connections of the Bosch injection valves EV 6, EV 12 and EV 14 are compatible.

Application

Fuel Filter Requirements

Particle size	≥ 5 µm
Max. particle size	35 µm
Separation rate	≥ 82 %

Technical Specifications

Mechanical Data

System pressure	Max. 8 bar
Weight	≤ 55 g
Fuel input	Top-feed injector
Operating temperature	-40 to 110°C
Permissible fuel temperatures	≤ 70°C

Climate-proof corresponding to saline fog test DIN 50 021

Housing design	Standard (S), Long (L)
Spray type	C (Conical Spray) or E (2-Spray)
Flow rate at 3 bar (n-heptane)	134 to 962 cm ³ /min 92 to 658 g/min
Spray angle α	15 to 70°
Bent angle γ	0 to 20°
Coil resistance	1.2 to 16 Ω
Fuel compatibility	E85 / M100 (after Methanol-operating the valves must be flushed with normal gasoline-fuel)

Electrical Data

Power supply	6 to 16.5 V
--------------	-------------

Connectors and Wires

Connectors	Jetronic, Sumitomo, Motorsport connectors
------------	---

Installation Notes

Please ask for more information before ordering.

Injectors with low resistance are only supplied with a peak and hold power stage.

Ordering Information

EV 6 CS, 116 g/min n-heptane
Order number 0 280 156 194

EV 6 CL, 261 g/min n-heptane
Order number 0 280 155 868

EV 6 EL, 261 g/min n-heptane
Order number 0 280 155 830

EV 6 ES, 269 g/min n-heptane
Order number 0 280 156 063

EV 6 CS, 310 g/min n-heptane
Order number 0 280 156 012

EV 6 CS, 658 g/min n-heptane
Order number B 280 434 499-02

Accessories

Clip for locking bush of plastic
Order number 2 431 314 004

Clip for locking bush of steel
Order number 2 431 314 011

Dimensions

Spray bent to the „right“, Delta=0°

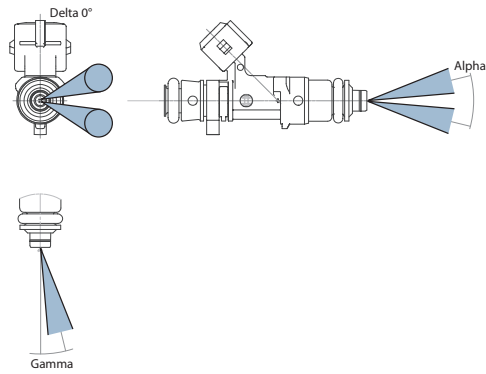

Spray bent „down“ (away from electr. connector), Delta=90°

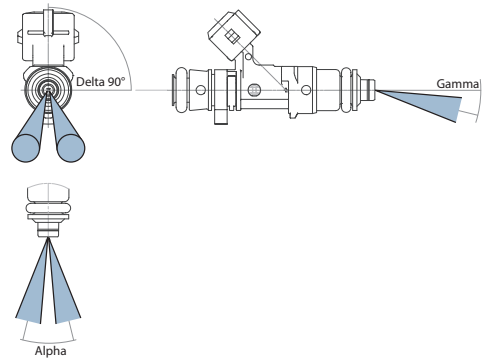

Spray bent to the „left“, Delta=180°

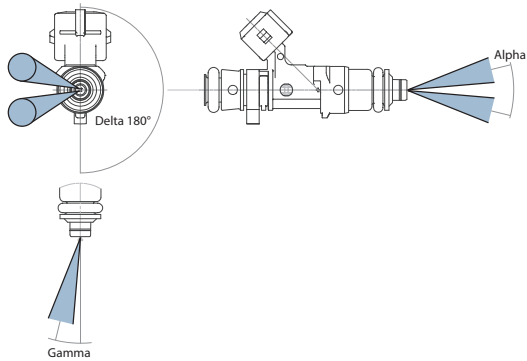

Spray bent „up“ (towards electr. connector), Delta=270°

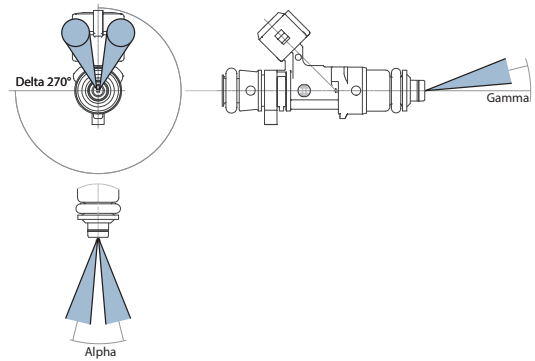

Delta Angel

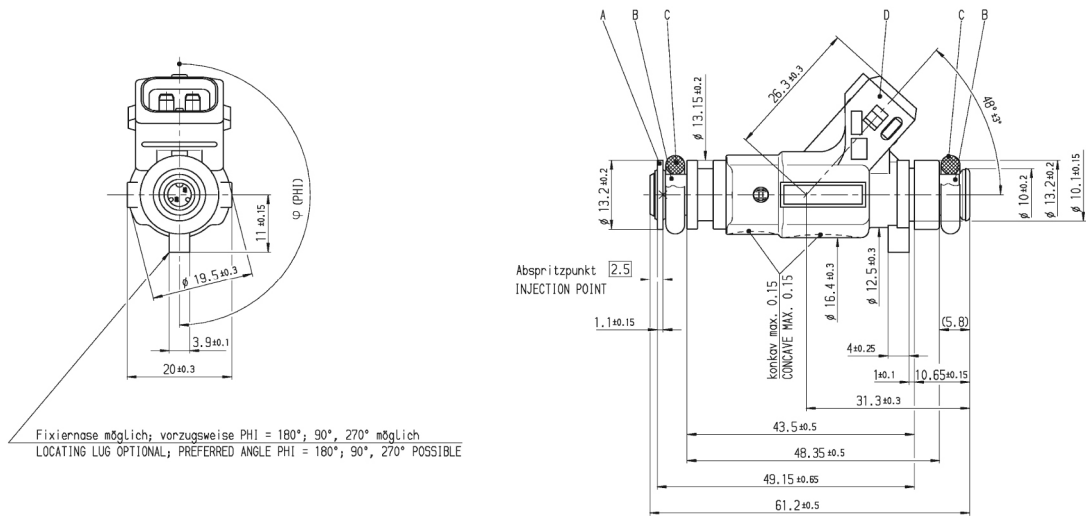

EV 6 Standard

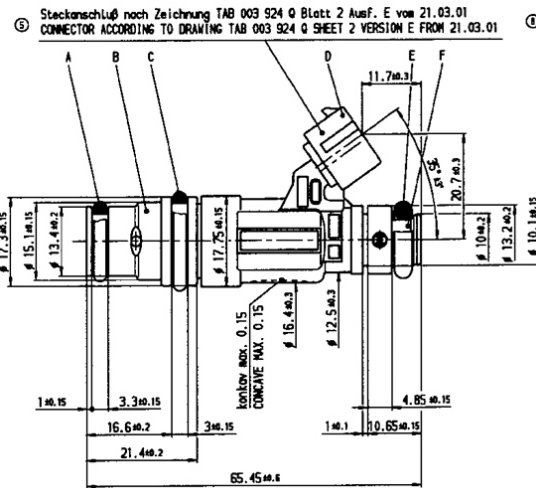

EV 6 Long

Version mit Stahl-Tasse
VERSION WITH STEEL-CUP

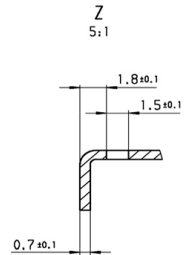
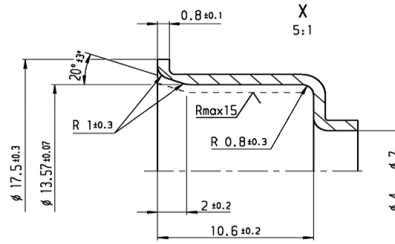
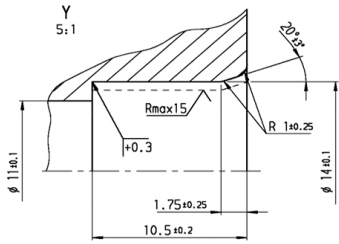

Version mit Kunststoff-Tasse
VERSION WITH PLASTIC-CUP

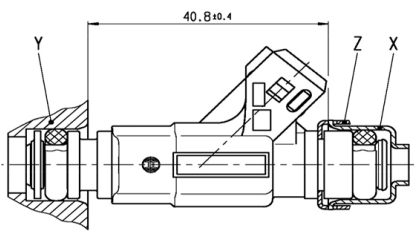

Mounting Instructions EV 6 Standard

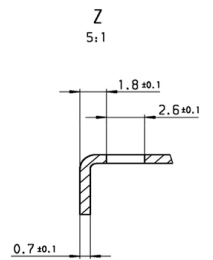
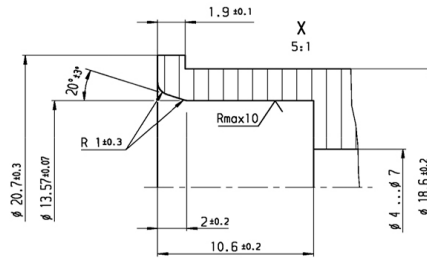

Version mit Stahl-Tasse
VERSION WITH STEEL-CUP

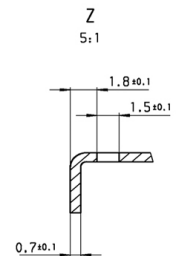
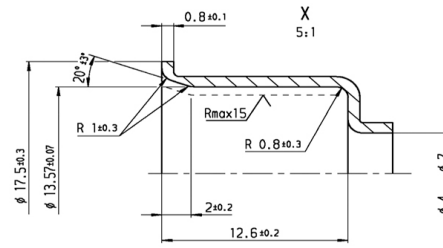
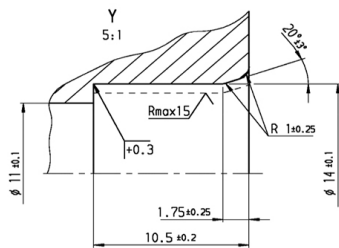

Version mit Kunststoff-Tasse
VERSION WITH PLASTIC-CUP

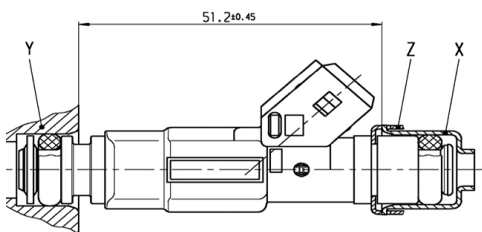

Mounting Instructions EV 6 Long

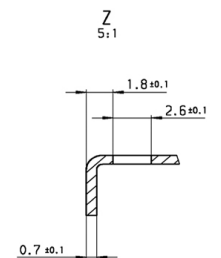
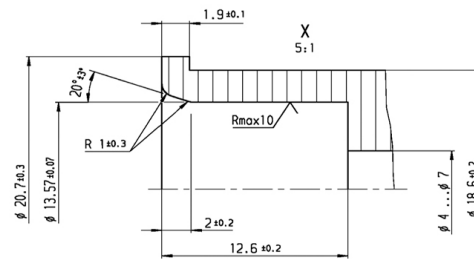

Represented by:

Europe:
Bosch Engineering GmbH
Motorsport
Robert-Bosch-Allee 1
74232 Abstatt
Germany
Tel.: +49 7062 911 9101
Fax: +49 7062 911 79104
motorsport@bosch.com
www.bosch-motorsport.de

North America:
Bosch Engineering North America
Motorsport
38000 Hills Tech Drive
Farmington Hills, MI 48331-3417
United States of America
Tel.: +1 248 876 2977
Fax: +1 248 876 7373
motorsport@bosch.com
www.bosch-motorsport.com

Latin America:
Robert Bosch Ltda
Motorsport
Av Juscelino Kubitscheck de
Oliveira 11800
Zip code 81460-900
Curitiba - Parana
Brasilia
Tel.: +55 41 3341 2057
Fax: +55 41 3341 2779

Asia-Pacific:
Bosch Engineering Japan K.K.
Motorsport
18F Queen's Tower C, 2-3-5 Minato Mirai
Nishi-ku, Yokohama-shi
Kanagawa 220-6218
Japan
Tel.: +81 45 650 5610
Fax: +81 45 650 5611
www.bosch-motorsport.jp

Australia, New Zealand and South Africa:
Robert Bosch Pty. Ltd
Motorsport
1555 Centre Road
Clayton, Victoria, 3168
Australia
Tel.: +61 (3) 9541 3901
motor.sport@au.bosch.com