

## Thermocouple Probe TCP-N / TCP-NF

A flexible N-type thermocouple for measuring of exhaust-gas temperatures.

TCP-NF is used in FIA F3 since 2005.



Mechanical data	
Thread	M12 x 1
Tightening torque	15 Nm
Wrench size	17 mm
Length	630 mm
Weight	60 g

Conditions for use	
Vibration	80 g/5 ... 500 Hz
DIN EN 60584	
Temperature range	-40 ... 115 °C

Characteristic	
DIN IEC 584	

Electrical data	
Power supply	12 V
Full scale output	0,5 ... 4,5 V
Thermocouple	NiCrSi-NiSi
Measuring range	-40 ... 1100 °C
Response time:	
TCP-N	20 s
TCP-NF	33 s

Connector	
TCP-N	1-J0973-70
TCP-NF	D 261 205 276

Part numbers	
TCP-N	<b>B 261 209 387</b>
TCP-NF	<b>B 261 209 821 01</b>

### Design TCP-N

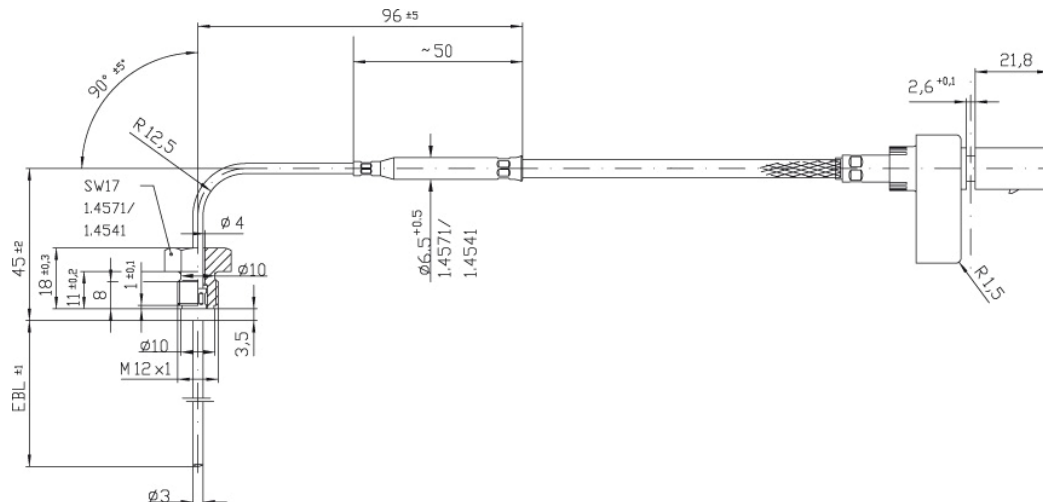

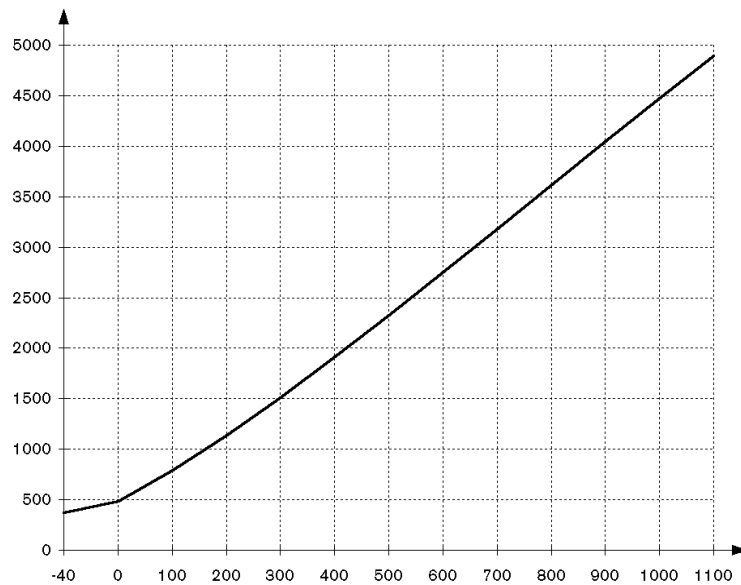
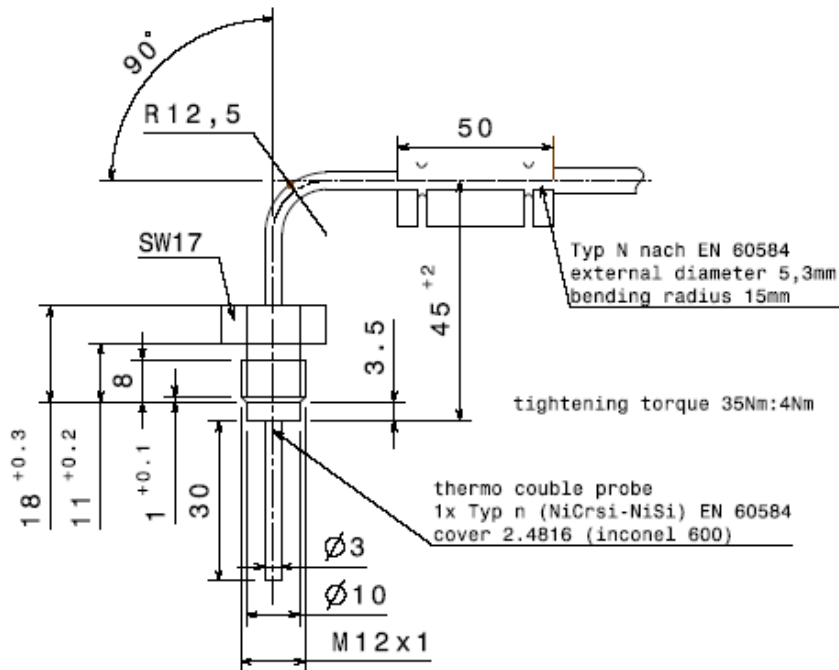
**Design TCP-NF**

Input °C	Output mV
-40	372
0	485
100	790
200	1135
300	1513
400	1912
500	2327

Input °C	Output mV
600	2752
700	3183
800	3615
900	4046
1000	4473
1100	4845