

Single Fire Coil P50/P50-M

www.bosch-motorsport.com



BOSCH
Invented for life



- ▶ Max. 35 kV
- ▶ Max. 50 mJ
- ▶ Max. 3.0 kV/μs
- ▶ High voltage contacting via high voltage wire and spark plug connector possible
- ▶ Max. 10,000 1/min

The single fire coil P50 is a low cost concept designed for direct mounting to the cylinder head. A high voltage ignition wire can optionally be connected to the secondary output terminal.

The P50 has no integrated transistor and requires an ECU with internal ignition power stages.

The coil P50-M is specifically for motorsport applications. This coil is operable in higher vibration environments.

Application

Spark energy	≤ 50 mJ
Primary current	≤ 8.5 A
Operating temperature range at outer core	-20 to 140°C
Storage temperature range	-40 to 100°C
Max. vibration	Please see Variations

Technical Specifications

Variations

	P50	P50-M
Max. vibration	≤ 400 m/s ² at 5 to 2,000 Hz	≤ 800 m/s ² at 5 to 2,000 Hz

Weight	223 g	265 g
Spark plug connector	-	+

Mechanical Data

Weight	Please see Variations
Mounting	Pluggable

Electrical Data

Primary resistance with wire	370 mΩ
Secondary resistance	Incapable of measurement
High voltage rise time	≤ 3.0 kV/μs
Max. high voltage at 1 MΩ 10 pF	≤ 35 kV
Spark current	≤ 92 mA
Spark duration at 1 kV 1 MΩ	≤ 1.15 ms
Noise suppression	With spark plug connector
Suppression diode / EFU	Integrated

Characteristic

Measured with power stage	IGBT IRG4BC40S (U _{ce} = 600 V)
---------------------------	--

Connectors and Wires

Connector	Bosch Compact
Mating connector	D 261 205 335-01
Pin 1	ECU Ignition power stage
Pin 2	Gnd
Pin 3	U _{batt}
Various motorsport and automotive connectors are available on request.	
For spark plugs	Ceramic diameter d=10 mm

Characteristic dwell times [ms]

U _{batt}	I _{primary}					
	5.0A	6.0A	7.0A	8.0A	9.0A	10.0 A
6V	3.84	4.93	6.2	7.7	9.5	11.2
8V	2.54	3.14	3.81	4.51	5.17	5.61
10V	1.9	2.33	2.76	3.21	3.62	3.87
12V	1.51	1.84	2.17	2.51	2.8	2.97
14V	1.26	1.52	1.79	2.06	2.29	2.42
16V	1.07	1.3	1.53	1.74	1.93	2.04
18V	0.94	1.13	1.32	1.51	1.67	1.77
24V	0.68	0.81	0.95	1.08	1.19	1.26
30V	0.53	0.63	0.74	0.84	0.93	0.98

Measured values are without loom resistance. Loom resistance must be less than the primary resistance. The needed dwell time is to be verified through current measurement

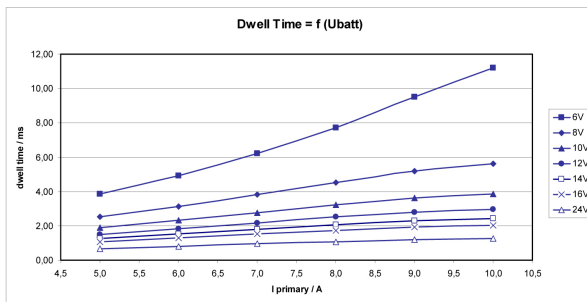

Dwell time

Spark energy and provided high voltage

I prim.	Spark energy	-duration	-current	Hi voltage
5 A	22 mJ	0.82 ms	60 mA	26.8 kV
6 A	29.7 mJ	0.93 ms	68.5 mA	31.6 kV
7 A	37.5 mJ	1.03 ms	77 mA	36.4 kV
8 A	46.3 mJ	1.12 ms	87.5 mA	40.9 kV

9 A	53 mJ	1.17 ms	97 mA	44.4 kV
10 A	58.4 mJ	1.21 ms	105 mA	46.3 kV

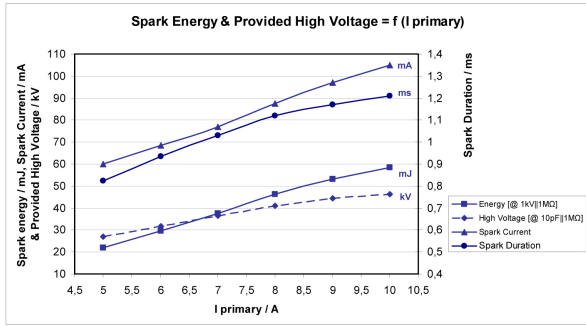

Spark energy

Installation Notes

During mounting of the spark plug please pay attention that full clamping and proper contacts are made to ensure safe connection between coil and spark plug.

The P50 has no integrated transistor and requires an ECU with internal ignition power stages, e.g. IGBT IRG4BC40S or BIP.

For technical reasons the values of the coils may vary.

Please regard the specified limit values.

Please find further application hints in the offer at our homepage.

In case of ignition-caused malfunctions, please use screened sensor wires.

Ordering Information

Coil P50

Order number **0 221 504 001**

Coil P50-M

Motorsport version

Order number **F 02U V00 869-01**

Accessories

Accessory spark plug connector

Order number **1 354 489 085**

Dimensions

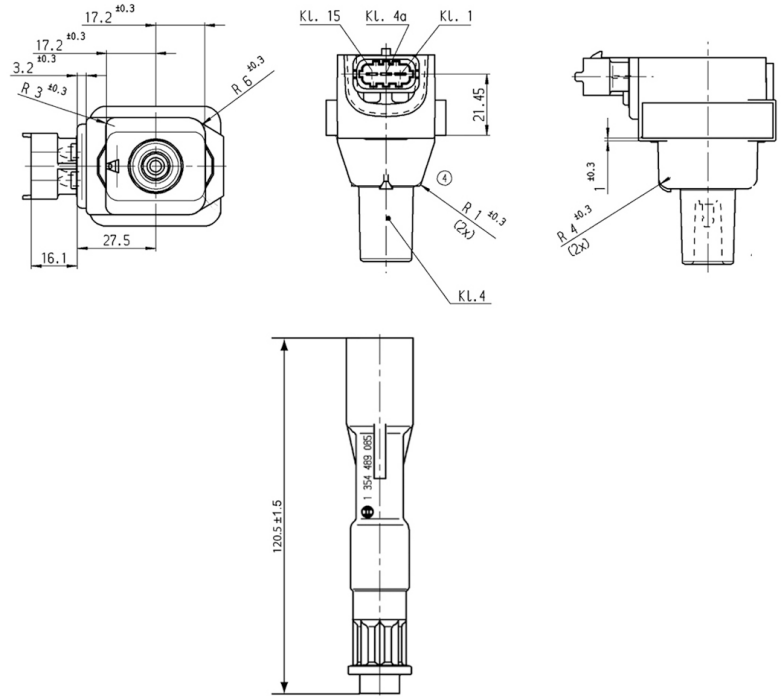

Represented by:

Europe:
 Bosch Engineering GmbH
 Motorsport
 Robert-Bosch-Allee 1
 74232 Abstatt
 Germany
 Tel.: +49 7062 911 79101
 Fax: +49 7062 911 79104
 motorsport@bosch.com
 www.bosch-motorsport.de

North and South America:
 Bosch Engineering North America
 Motorsports
 38000 Hills Tech Drive
 Farmington Hills, MI 48331-3417
 United States of America
 Tel.: +1 248 876 2977
 Fax: +1 248 876 7373
 motorsport@bosch.com
 www.bosch-motorsport.com

Asia-Pacific:
 Bosch Engineering Japan K.K.
 Motor Sport Department
 3-33-8 Tsuruya-cho, Kanagawa-ku, Yokohama-shi
 Kanagawa 221-0835
 Japan
 Tel.: +81 45 410 1650
 Fax: +81 45 410 1651
 motorsport@bosch.com
 www.bosch-motorsport.com