

Fuel Pressure Regulator Mini 2



- ▶ 5 to 10 bar
- ▶ 30 to 400 l/h reflow
- ▶ Adjusted at 105 l/h
- ▶ Aluminum housing
- ▶ All versions Methanol compatible

Fuel pressure regulators are used to maintain constant fuel pressure at the injection valves.

We offer this regulator for gasoline as well as for methanol applications.

The main benefit of this regulator includes a higher pressure range and a higher return flow rate in comparison to the production type regulators.

Application

Pressure range	See ordering information
Reflow quantity	30 to 400 l/h
Fuel compatibility	Gasoline, E85, M100
Operating temperature	-40 to 120°C
Storage temperature	-40 to 100°C
Max. vibration	<600 m/s ² at 5 to 250 Hz
Valve leakage	$Q_{leak} [cm^3/min] \leq 9$ (pneumatic) at $p [kPa] = 0.8 \times P_{nom}$

Technical Specifications

Variations

Please see Ordering Information

Mechanical Data

Diameter	38.1+0.1-0.2 mm
Weight	Ca. 61 g
Mounting	Fastening with a clip

Connectors and Wires

Connector supply	Diam. 25 mm, O-ring 25x2.5
Connector reflow	Diam. 9.1 mm, O-ring 5x2.5

Installation Notes

Never run the regulator without the integrated filter.

Please oil O-rings lightly with clean and silicone free engine oil before you install the regulator.

Please make a leak test after you have installed the regulator.

When the pressure regulator is removed and will be reused, the O-rings must be tested for fractures.

Operation of the pressure regulator with a medium other than gasoline is not allowed.

Using the FPR Adaptor light F02U.V02.248-01, you can rebuild the regulator an inline type.

This pressure regulator is not designed for in-tank mounting.

Legal Restrictions

Due to embargo restrictions, sale of this product in Russia, Belarus, Iran, Syria, and North Korea is prohibited.

Ordering Information

Fuel Pressure Regulator Mini 2

Pressure Range 5.0 bar
Order number **F02U.V02.166-01**

Fuel Pressure Regulator Mini 2

Pressure Range 6.0 bar
Order number **F02U.V02.168-01**

Fuel Pressure Regulator Mini 2

Pressure Range 7.0 bar
Order number **F02U.V02.170-01**

Fuel Pressure Regulator Mini 2

Pressure Range 8.0 bar
Order number **F02U.V02.171-01**

Fuel Pressure Regulator Mini 2

Pressure Range 10.0 bar
Order number **F02U.V02.172-01**

FPR Adaptor Light

Order number **F02U.V02.248-01**

Dimensions

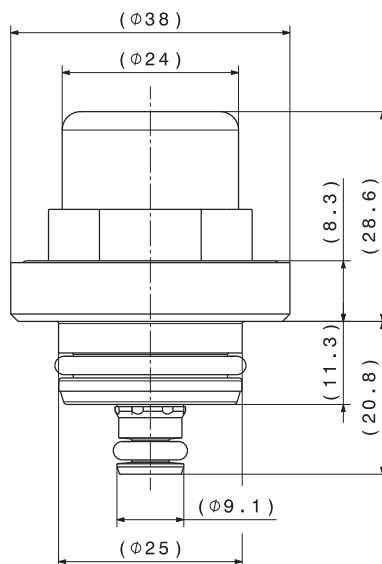

Complete dimensions on offer drawing at www.bosch-motorsport.com

Represented by:

Europe:
Bosch Engineering GmbH
Motorsport
Robert-Bosch-Allee 1
74232 Abstatt
Germany
Tel.: +49 7062 911 9101
Fax: +49 7062 911 79104
motorsport@bosch.com
www.bosch-motorsport.de

North America:
Bosch Engineering North America
Motorsport
38000 Hills Tech Drive
Farmington Hills, MI 48331-3417
United States of America
Tel.: +1 248 876 2977
Fax: +1 248 876 7373
motorsport@bosch.com
www.bosch-motorsport.com

Asia-Pacific:
Bosch Engineering Japan K.K.
Motorsport
18F Queen's Tower C, 2-3-5 Minato
Mirai Nishi-ku, Yokohama-shi
Kanagawa 220-6218
Japan
Tel.: +81 45 650 5610
Fax: +81 45 650 5611
www.bosch-motorsport.jp

Australia, New Zealand and South Africa:
Robert Bosch Pty. Ltd
Motorsport
1555 Centre Road
Clayton, Victoria, 3168
Australia
Tel.: +61 (3) 9541 3901
motor.sport@au.bosch.com